

CRAB

design: Maurizio Di Lauro

MOBILE CONTENITORE

Dimensioni:

L 174 x P 55 x H 82 cm
L 174 x P 55 x H 73 cm
L 200 x P 55 x H 82 cm
L 200 x P 55 x H 73 cm

Materiali:

Struttura: legno massello e tranciato di palissandro / rovere / noce canaletto.
Piano: legno massello e tranciato di palissandro / rovere / noce canaletto / gres porcellanato.
Ante: legno massello e tranciato di palissandro / rovere / noc canaletto / ottone / gres porcellanato.



CABINET

Dimensions:

L 174 x W 55 x H 82 cm
L 174 x W 55 x H 73 cm
L 200 x W 55 x H 82 cm
L 200 x W 55 x H 73 cm

Materials:

Structure: solid wood and oak veneer / Solid wood and rosewood veneer / Solid wood and walnut veneer.
Top: solid wood and oak veneer / Solid wood and rosewood veneer / Solid wood and walnut veneer / porcelaine stoneware.
Doors: solid wood and oak veneer / Solid wood and rosewood veneer / Solid wood and walnut veneer / brass / porcelaine stoneware.

CRAB MOBILE CONTENITORE / CABINET

Piano in legno / *Wooden top*

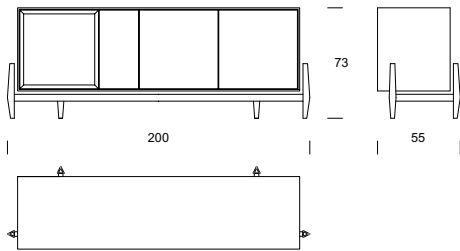

Piano in legno / *Wooden top*

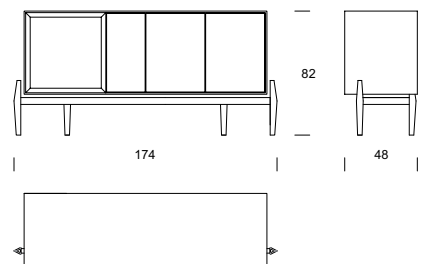
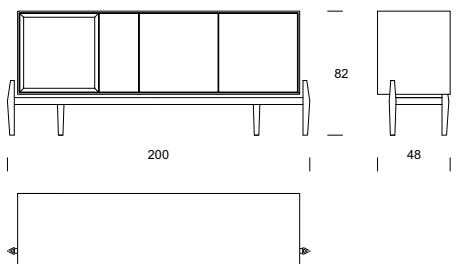
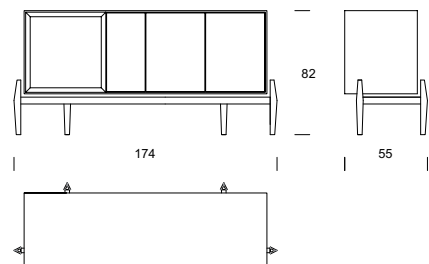
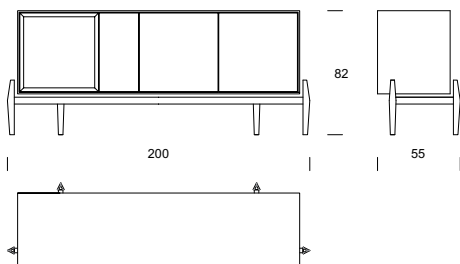
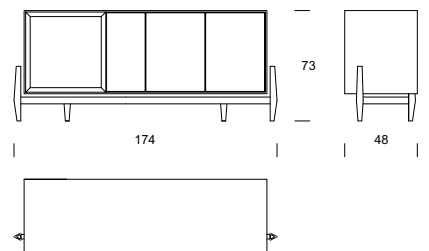
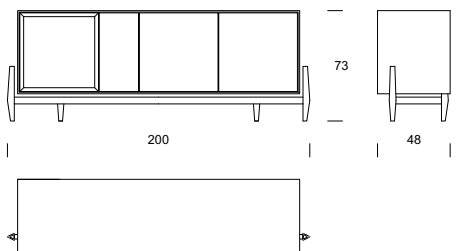
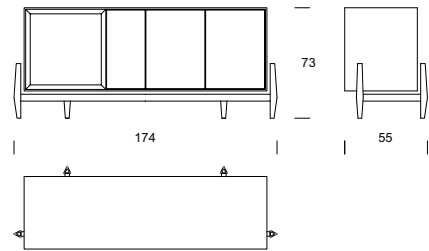

CRAB MOBILE CONTENITORE / CABINET

Piano in marmo / *Marble top*

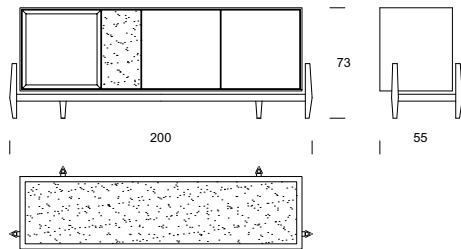

Piano in marmo / *Marble top*

